

# Heavy Duty Cable Clamps

561-B0125, 561-B0187, 561-B0250, 561-B0312, 561-B0375, 561-B0437, 561-B0500, 561-B0562, 561-B0625, 561-B0750, 561-B1000, 561-B1250, 561-B1375, 561-B1500

**Date Last Revised: 2/13/14**

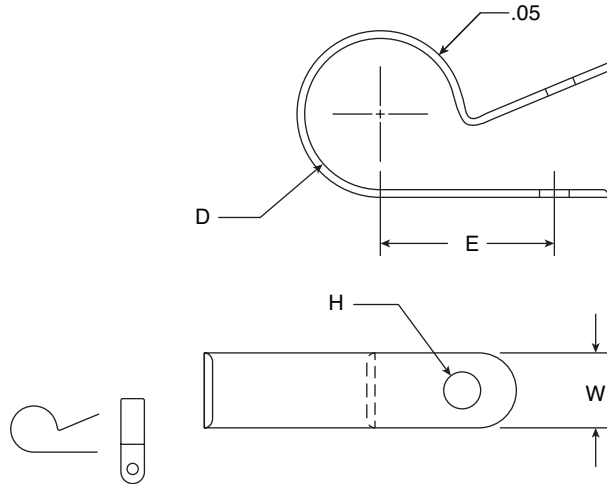

Molded nylon cable clamps secure, insulate, and route cable, wiring, tubing, piping, and fiber optics. These tough, durable, chemical resistant Nylon 6/6 cable clamps are perfect for applications in electronics, automotive, air craft, appliance, and many other industries.

The Heavy Duty Series provides a full 1/2" wide contact area to all critical and heavy duty industrial and commercial applications. All contact edges have a full radius for product protection. Sizes are clearly marked on each clamp.

### Dimensions: in.

| Part Number | Description            | D     | W            | H            | E     |
|-------------|------------------------|-------|--------------|--------------|-------|
| 561-B0125   | Heavy Duty Cable Clamp | 0.125 | 0.500(±.015) | 0.203(±.015) | 0.315 |
| 561-B0187   | Heavy Duty Cable Clamp | 0.187 | 0.500(±.015) | 0.203(±.015) | 0.425 |
| 561-B0250   | Heavy Duty Cable Clamp | 0.250 | 0.500(±.015) | 0.203(±.015) | 0.410 |
| 561-B0312   | Heavy Duty Cable Clamp | 0.312 | 0.500(±.015) | 0.203(±.015) | 0.500 |
| 561-B0375   | Heavy Duty Cable Clamp | 0.375 | 0.500(±.015) | 0.203(±.015) | 0.530 |
| 561-B0437   | Heavy Duty Cable Clamp | 0.437 | 0.500(±.015) | 0.203(±.015) | 0.560 |
| 561-B0500   | Heavy Duty Cable Clamp | 0.500 | 0.500(±.015) | 0.203(±.015) | 0.595 |
| 561-B0562   | Heavy Duty Cable Clamp | 0.562 | 0.500(±.015) | 0.203(±.015) | 0.606 |
| 561-B0625   | Heavy Duty Cable Clamp | 0.625 | 0.500(±.015) | 0.203(±.015) | 0.655 |
| 561-B0750   | Heavy Duty Cable Clamp | 0.750 | 0.500(±.015) | 0.203(±.015) | 0.780 |
| 561-B1000   | Heavy Duty Cable Clamp | 1.000 | 0.500(±.015) | 0.203(±.015) | 0.910 |
| 561-B1250   | Heavy Duty Cable Clamp | 1.250 | 0.500(±.015) | 0.203(±.015) | 1.060 |
| 561-B1375   | Heavy Duty Cable Clamp | 1.375 | 0.500(±.015) | 0.203(±.015) | 1.125 |
| 561-B1500   | Heavy Duty Cable Clamp | 1.500 | 0.500(±.015) | 0.203(±.015) | 1.190 |

RoHS Compliant

**Available from Mouser Electronics**  
**1-800-346-6873**  
**www.mouser.com**

EPD-200927